

AiW-4111

Based on FMCW - Frequency Modulated Continuous Wave technology planar array hydrological radar level transmitter. A burger shape and compact FMCW radar for water measurement. Wireless connectivity of Bluetooth or Wi-Fi on mobile.

Higher accuracy and faster response time for rapid level changes. Very easy to be installed by universal joint bracket to fit in various conditions in the wild or process monitoring. Fully enclosed IP68 waterproof protection with bubble level and lightning protection.



Technical Specifications

| | |
|-----------------------|--|
| Frequency | 24.0 GHz to 26.0 GHz RF power < 30 uW |
| Measuring Range | 0.1 to 55 m |
| Accuracy | ± 3 mm |
| Beam Angle | 10° |
| Antenna | Planar array, POM / PTFE |
| Communication | RS485 Modbus / Bluetooth PLC / all RTU manufacturers' protocols |
| Signal Output | RS485 |
| Operating Temperature | -55 to 85 °C |
| Operating Pressure | 860 to 1060 mbar (12.47 to 15.37 psi) |
| Power Supply | four-wire, 9 to 38 VDC (< 0.08W) |
| Configuration Tools | PC software Bluetooth or Wi-Fi with APP or WeChat mini program |
| Process Connection | M6, universal joint bracket mounting |
| Electrical Connector | M12, 4 pin aviation connector |
| Housing Material | Anodized aluminum |
| Protection | IP67 / IP68 |
| Dimensions | 126 mm x 126 mm x 45 mm |

Notes

- Support for extended features of one relay alarm output (250VAC/5A) or 4-20mA output.
- Support for extended features of radar angle signals, ambient temperature, and altitude outputs.
- Support for extended features of GPRS or IoT connections.
- Support for customized protocols.

*Built-in professional hydrological echo algorithms
Compact structure, remote monitoring
Configure on your mobile*



Typical Applications

- Drains
- Wastewater treatment
- Rivers and lakes
- Open-channel
- City manhole cover
- Reservoir
- Agricultural irrigation
- Tides

Dimensions

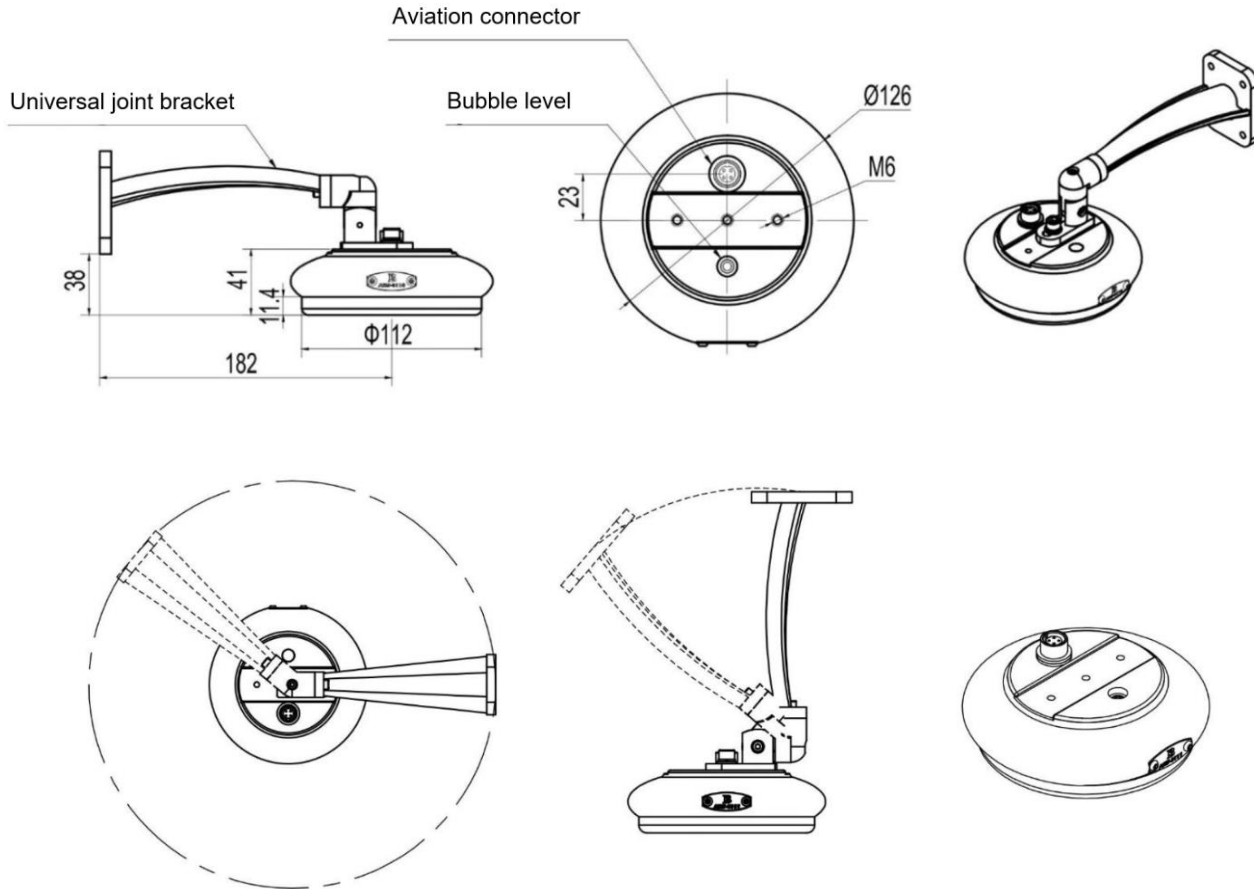

Connections

| | | | |
|---------|------------|-----------|-----------|
| 1 – RED | 2 – YELLOW | 3 – BLUE | 4 – GREEN |
| V+ | V- | RS485 – A | RS485 – B |

Ordering Code

| AiW-4111 | 1 | 2 | 3 | 4 | Description |
|----------|---|-------------------|-----------|------------------------|-------------|
| | S | RS485 with Modbus | | | |
| | H | 4-20mA with HART | | | |
| | T | IoT | | | |
| | G | RTU & GPRS | | | |
| | | BT | Bluetooth | | |
| | | WF | Wi-Fi | | |
| | | | Y | One Relay Alarm Output | |
| | | | N | None | |
| | | | NL | POM | |
| | | | PT | PTFE | |

typical product number
AiW-4111-S-BT-N-NL